**KWVE15-W**

Recirculating ball bearing carriage

Carriages KWVE..-W, wide carriage for linear recirculating ball bearing and guideway assembly

Teknik bilgiler

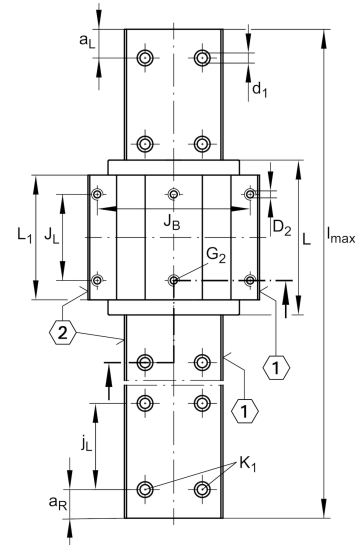
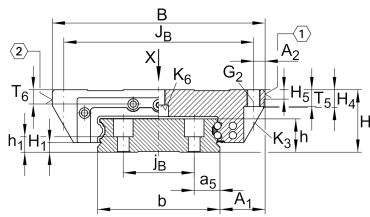

Mevcut ürün modeliniz

Size code	15	
Version	Version	
Carriage design	W	Wide carriage and wide guideway

Main Dimensions & Performance Data

H	21 mm	Height system
B	68 mm	Width carriage
L	55,6 mm	Overall length carriage
C	7.200 N	Dynamic load rating
C ₀	14.500 N	Static load rating
M _{0x}	332 Nm	Static moment rating about X axis
M _{0y}	100 Nm	Static moment rating about Y axis
M _{0z}	100 Nm	Static moment rating about Z axis
m	0,27 kg	Ağırlık

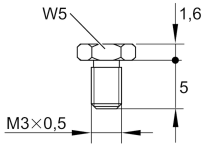
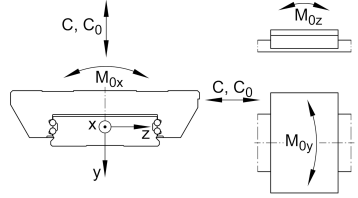
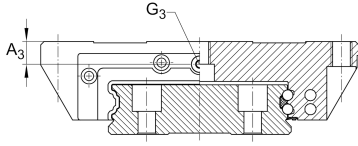

S16

Mounting dimensions

A ₁	15,5 mm	Distance from locating edge on carriage to locating edge on guideway
J _B	60 mm	
b	37 mm	Width rail
A ₂	4 mm	Distance from locating edge to hole
L ₁	39,8 mm	
J _L	29 mm	
H ₁	2,1 mm	Free space, system dimension
H ₄	7,7 mm	
H ₅	4,5 mm	
T ₅	7 mm	Thread depth
T ₆	4,8 mm	
G ₂	M5	Fixing screws above (DIN ISO 4762-12.9)
G ₂ M _A	5,8 Nm	Maximum tightening torque
K ₃	M4	Fixing screws below (DIN ISO 4762-12.9)
K ₃ M _A	5 Nm	Maximum tightening torque
K ₆	M4	Fixing screws below (DIN 7984-8.8)
K ₆ M _A	2 Nm	Maximum tightening torque
D ₂	4,5 mm	
A ₃	3,6 mm	Position lubrication connector
G ₃	M3	Lubrication connector
t G ₃	4 mm	Maximum permissible screw depth for lubrication connectors

Additional information

VMKB_065	KWVE	Material name
----------	------	---------------